



**All-in-One Ultra Slim
LED Display Solutions**

About Calibre

Calibre is a multi-award winning UK based company established in 1988. It is respected world-wide for providing proprietary image scaling technology. In 2017, Calibre was acquired by Coretronic Corporation, a world leading display solution provider.

The All-in-One (AiO) LED Display Series is the result of the cooperation between the two companies. All models are based on a new innovative system design providing the perfect solution for a multitude of demanding ProAV market applications.



Key Features



Easy Setup

3 people x 1 hour for initial installation



Easy Operation

Simple to use by App or remote control
(Built-in Media Player)

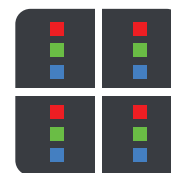

Robust

4 IN 1 SMD
strengthened LED Panel
(for A130-15 model)

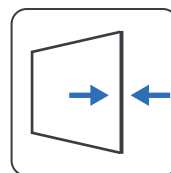

Ultra Slim

Aluminum sheet metal
design < 38mm thickness



Power Saving

Standby mode to minimize
your power to 0.5W

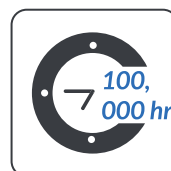

Long Lifetime

100,000 hr

Advanced Visual Experience

Seamless

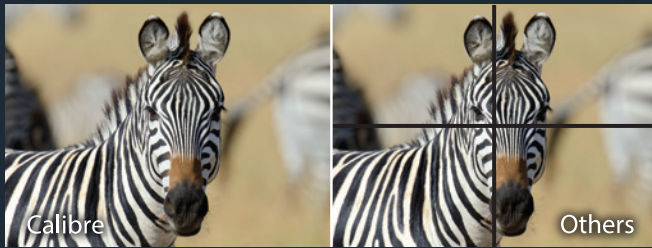

Very Fine Pixel pitches ensure vivid images

High Refresh Rate



>3000 Hz

True Color Replication



Superior color gamut to represent true color

High Contrast



5000:1

Smooth Gradient

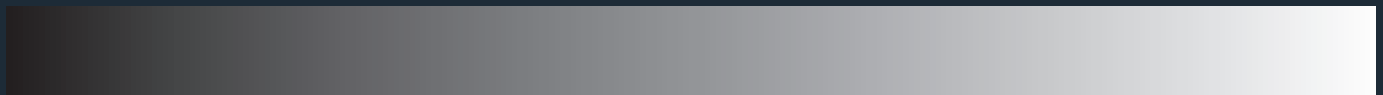

Adjustable Brightness

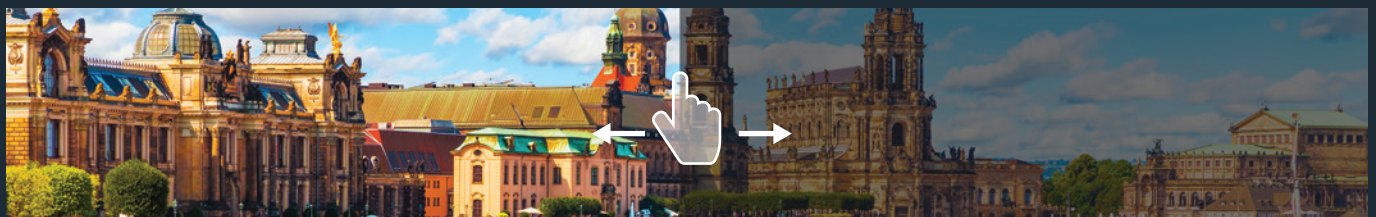

Simple quick brightness adjustment with remote control or App

HQUltra 4K Scaling

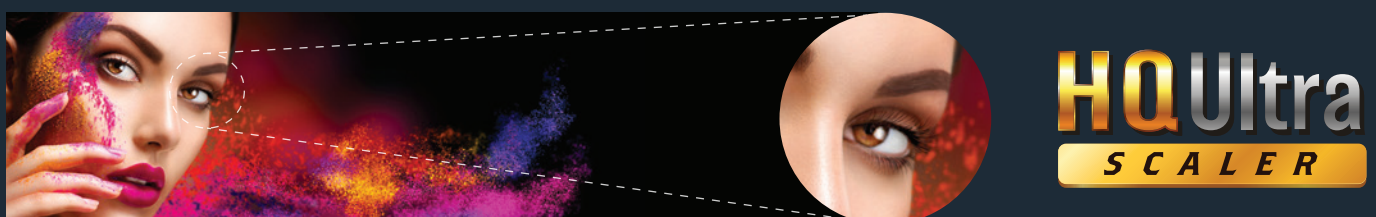

Up to 4K Image Scaling Quality with low latency video processing

Application

Boardroom / Lecture Hall



Seamless

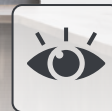

Brilliant color



Movable



PIP

Lighten up any room and fill it with exceptionally brilliant colors. In addition, it's modular and light-weight design simplifies the assembly task and lets you easily move the display it to any location in the room.

Broadcast



High refresh rate

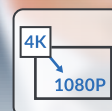

4K scaling



High contrast

Whether it is for news, events or a showcase, AIO LED display will truly present your content the way you want it to be. With 4K processing your audience will experience the very best visual experience both at home and in the studio.

Semi-outdoor Signage



Use AIO LED Display and amaze your visitors. With adjustable brightness, contrast and simple to use remote control your content will always look its best.

- Ultra slim
- Adjustable brightness
- Power stand by

Retail

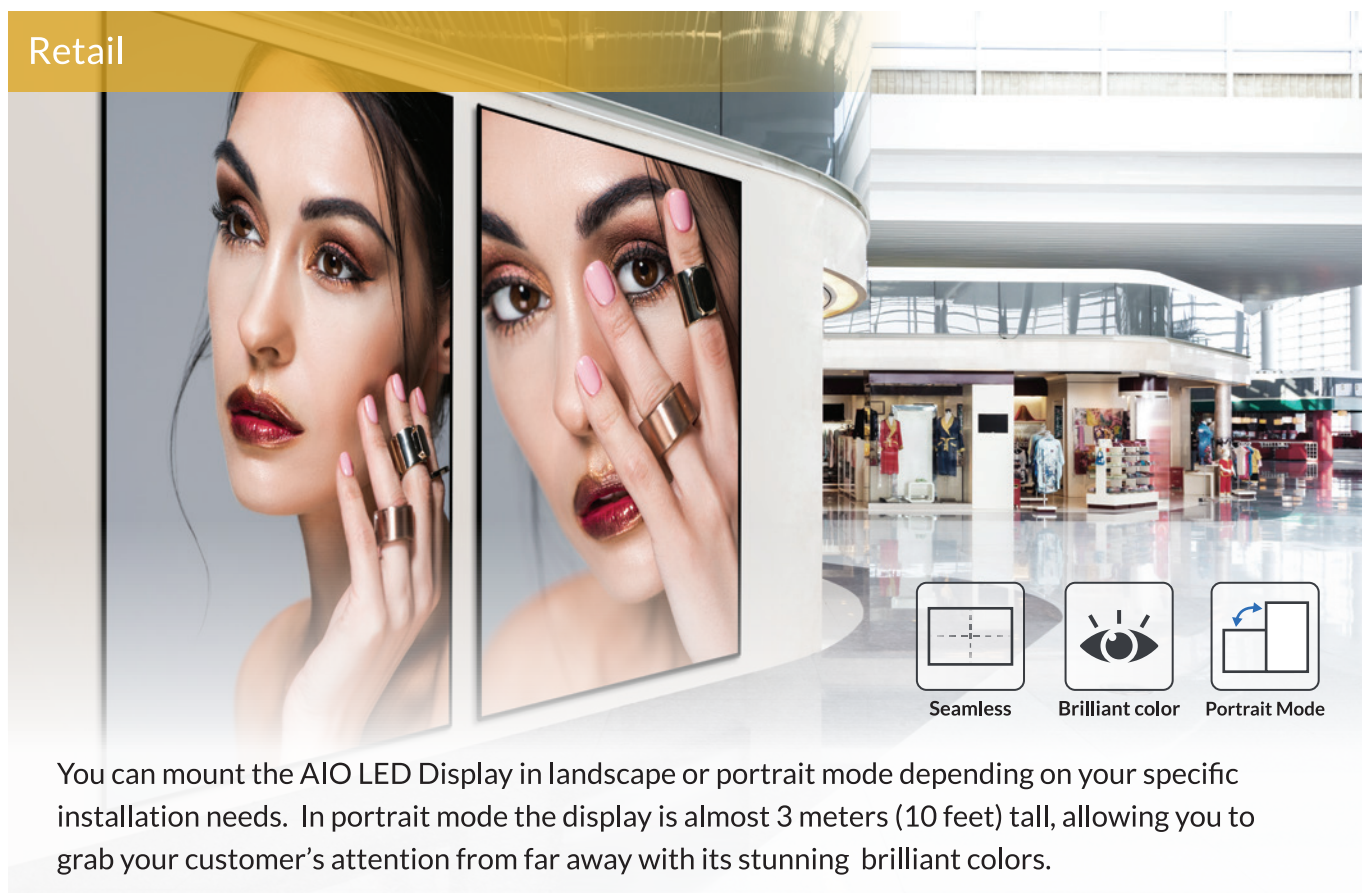

You can mount the AIO LED Display in landscape or portrait mode depending on your specific installation needs. In portrait mode the display is almost 3 meters (10 feet) tall, allowing you to grab your customer's attention from far away with its stunning brilliant colors.

- Seamless
- Brilliant color
- Portrait Mode

Installation & Maintenance

3 Steps Installation

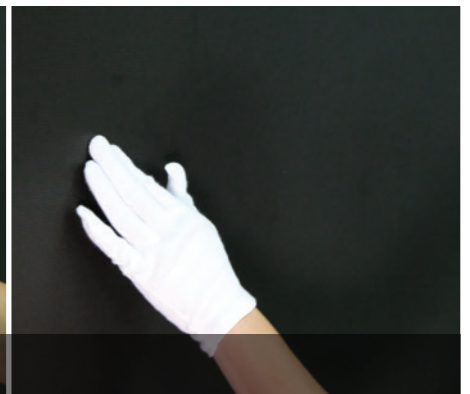
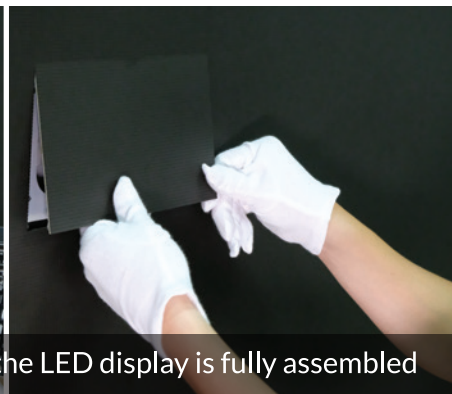
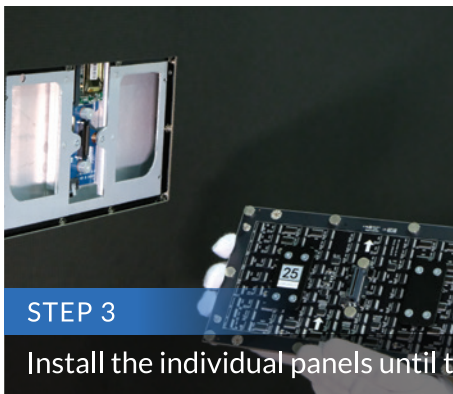
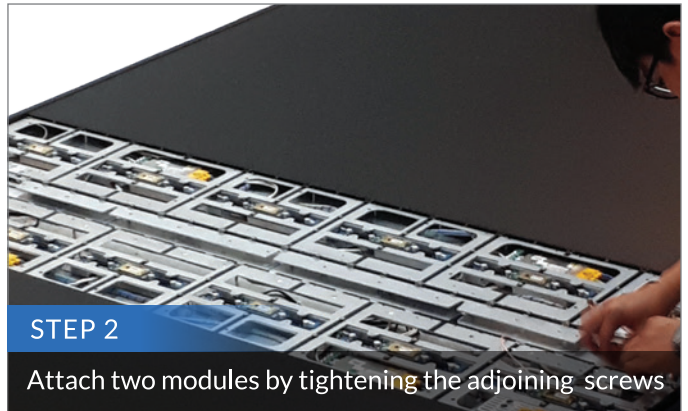
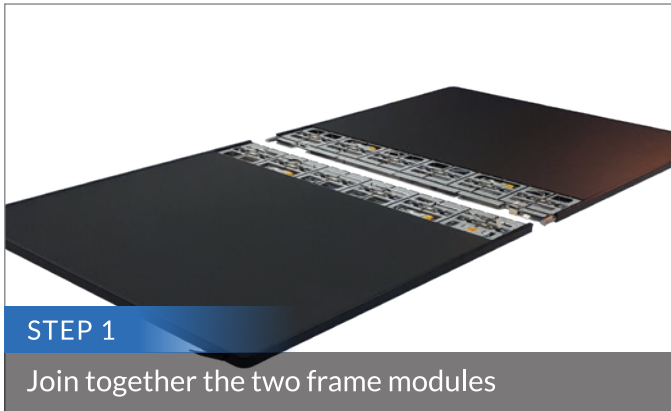

Front Maintenance

Less than 10 seconds to change an LED module



Time Saving





Model Name	LEDFusion A120	LEDFusion A130	LEDFusion A160
Size	120"	130"	163"
Resolution (W x H)	1408 x 792	1920 x 1080	1920 x 1080
Display Area (W x H)	2640 x 1485 mm	2880 x 1620 mm	3600 x 2025 mm
Dimensions (W x H x D) with Bezel	2644 x 1489 x 35 mm	2919 x 1659 x 38 mm	3604 X 2029 X 35 mm
Weight	110 kg / 242 lb	125 kg / 275.5 lb	191 kg / 421 lb
Panel Size (W x H)	240 x 135 mm	240 x 135 mm	240 x 135 mm
Panel Resolution (W x H)	128 x 72	160 x 90	128 x 72
IC Type	Common Anode	Common Anode	Common Anode
LED Type	4in1 SMD	4in1 SMD	4in1 SMD
Pixel Pitch	1.875 mm	1.5 mm	1.875 mm
Brightness	1000 nit	600 nit	700 nit
Color Depth	16 bits	16 bits	16 bits
Contrast Ratio	5,000 : 1	5,000 : 1	5,000 : 1
Viewing Angle (Max)	170°	170°	170°
Display Refresh Rate	3840 Hz @24 Scan	> 3000 Hz	3840 Hz @24 Scan
Color Temperature	6500 K	6500 K	6500 K
Operating Voltage	AC 200V-240V	AC 200V -240V	AC 200V-240V
I / O	HDMI-1.4b*1 & HDMI Loop*1, HDMI-1.4a*1, HDMI Monitor_output*1, 3G-SDI*1, USB*2, HDBaseT *1, Audio Line_out 3.5mm*1, RS232_in, RS232_out, RJ45 LAN Control	HDMI*2, VGA*1, 3G-SDI*1, USB*4, HDBa- seT*1, RS232*1, LAN Control	HDMI-1.4b*1 & HDMI Loop*1, HDMI-1.4a*1, HDMI Monitor_output*1, 3G-SDI*1, USB*2, HDBaseT *1, Audio Line_out 3.5mm*1, RS232_in, RS232_out, RJ45 LAN Control,
Power (Max)	2300 W	3000 W	3000 W
Flight Case Dimension	176(W) X 72(D) X 191(H) cm	176(W) X 72(D) X 191(H) cm	216.7(W) X 106.9(D) X 185.3(H) (total 3 flight cases)
Flight Case Net Weight	130 kg / 286.6 lb	165 kg / 363.8 lb	(1) 35.5kg / 78lb (2) 39kg / 85lb (3) 43.5kg / 95lb
Total Packing Weight (with accessories)	287 kg / 632.7 lb	313.8 kg / 691.8 lb	369kg / 813lb
Operating Condition	Temp.: -10°C ~ +40°C ; Humidity: 10% ~ 85%		
Safety Certification	     		



✉ proavsales@calibreuk.com

🖱 www.calibreuk.com

📞 **America** +1 (916) 282-1067
China +86 95013 5890 6926

Europe +44 1274940770
APAC, Australia & NZ +886 989 997068

📍 **UK Office** Cornwall House, Cornwall Terrace, Bradford, BD8 7JS
APAC Office No. 11, Li Hsing Rd., Science Park, Hsinchu, Taiwan, R.O.C.

Follow Us on



A *Coretronic* Company